



Crate grab with tipping device model TKA/d

Capacity 150 kg

The crate grab with tipping device is an absolutely safe unit, which not only securely transports stacking boxes, but can empty them in mid-air as well.

A safety lever system prevents the accidental opening of the grab.

The clamping jaws tightly grab under the rim of the crate without damaging the crate. To engage the tipping motion in order to empty the crate, the safety lock must be manually unlocked. The tipping motion is limited to 100°. This prevents the crate from flipping completely over while emptying, thereby reducing the risk of injury.

Option

Grabs for other sizes of crates are available upon request.

Please provide the crate dimensions or a sample crate when ordering.

Technical data model TKA/d

| Model | EAN-No. 4025092* | Capacity kg | Weight kg |
|---------------|---------------------|----------------|--------------|
| TKA 0.15/330d | *551519 | 150 | 25.8 |
| TKA 0.15/480d | *552103 | 150 | 26.0 |

Dimensions model TKA/d

| Model | TKA 0.15/330d | TKA 0.15/480d |
|-------|---------------|---------------|
| A, mm | 200 - 300 | 300 |
| B, mm | 315 - 330 | 470 - 480 |
| L, mm | 465 - 540 | 550 - 660 |

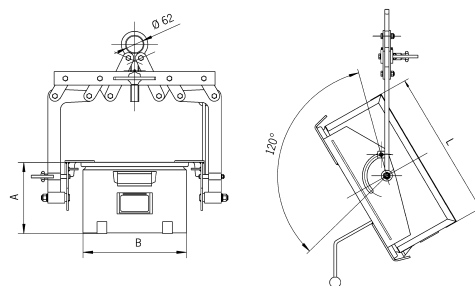

Model TKA.../...d